



6014-Z Deep groove ball bearings

- SKF Explorer

Deep groove ball bearings

Bearing data

[Tolerances](#),

Normal (metric), P6, P5, Normal (inch),

[Radial internal clearance](#),

Matched bearing pairs, Stainless steel
d < 10 mm, Other bearings

Bearing interfaces

[Seat tolerances for standard conditions](#),

[Tolerances and resultant fits](#)

Technical specification

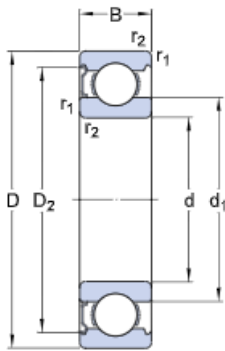

DIMENSIONS

d	70 mm	Bore diameter
D	110 mm	Outside diameter
B	20 mm	Width
d ₁	≈ 82.85 mm	Shoulder diameter
D ₂	≈ 99.9 mm	Recess diameter
r _{1,2}	min. 1.1 mm	Chamfer dimension

ABUTMENT DIMENSIONS

d _ε min.	76 mm	Diameter of shaft abutment
d _ε max.	82.8 mm	Diameter of shaft abutment
D _i max.	104 mm	Diameter of housing abutment
r _a max.	1 mm	Radius of shaft or housing fillet

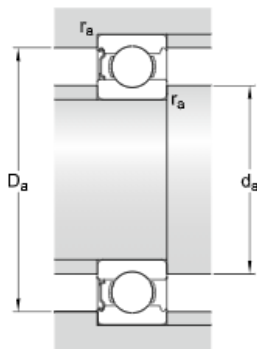

CALCULATION DATA

C	39.7 kN	Basic dynamic load rating
C ₀	31 kN	Basic static load rating
P _u	1.32 kN	Fatigue load limit
	13 000 r/min	Reference speed
	8 000 r/min	Limiting speed
k _r	0.025	Minimum load factor
f ₀	15.6	Calculation factor

MASS

	0.62 kg	Mass bearing
--	---------	--------------

TOLERANCE CLASS

P6		Dimensional tolerances
P6		Radial run-out